

Let's grow...flow!

PV32 series



pneumatic components

PV32 series

With its excellent sealing and long life seals, PV32 series covers applications where high flow rate of air or vacuum are needed.

Con un'ottima durata e tenuta di otturatori e membrana, la serie PV32 è impiegata dove sono richieste alte portate d'aria o vuoto.

The poppet + diaphragm system grants very high speed in reaching the max flow as well as high frequency of operations.

Il sistema ad otturatori + pilotaggio a membrana garantisce il raggiungimento della totale portata con grande velocità e frequenze di azionamento molto elevate.

N.C. and N.O. functions with solenoid or pneumatic operator

Funzioni 3/2 N.C. e 3/2 N.A. con pilotaggio pneumatico o elettropneumatico

External air supply for vacuum or low pressure inlet air
Alimentazione esterna del pilotaggio per funzionamento con vuoto o bassa pressione

Working conditions : -20°C +60°C, 3-10 bar, no lubrication needed

Condizioni lavoro : -20°C +60°C, 3-10 bar, lubrificazione non necessaria

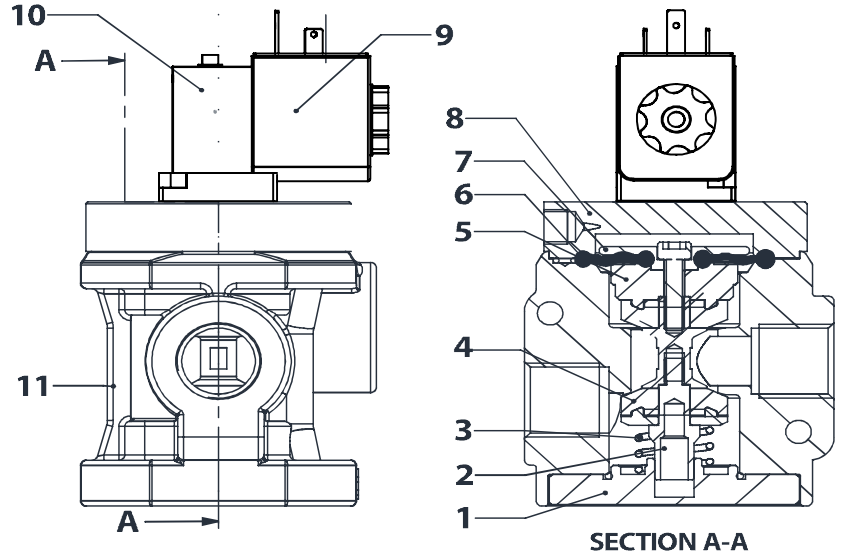

PART	DESCRIPTION	MATERIAL	TREATMENT
1	BOTTOM END CAP	ALLOY 11S	ANODIZED
2	SHUTTER GUIDE	STEEL	KANIGEN
3	SPRING	STAINLESS STEEL	
4	POPPET	PU 85 SH	MAX 10 Bar / -30 + 80°C
5	PISTON	P.O.M.	
6	DIAPHRAGM	PU 85 SH	MAX 10 Bar / -30 + 80°C
7	PISTON HOLDER	ALLOY 11S	
8	TOP END CAP	ALLOY 11S	ANODIZED
9	COIL		
10	SOLENOID OPERATOR	ALLOY 2011	ANODIZED
11	VALVE BODY	ALLOY 11S	POLISHING+PICKLING

New 3/2 balanced poppet valve from size G 1/2" to G 2"
Nuova serie di valvole 3/2 ad otturatore con taglie da 1/2" a 2"

Very high flow rate : from 5.500 NI/min to 60.000 NI/min
Alte portate comprese fra 5.500 NI/min e 60.000 NI/min

Available both for compressed air and for vacuum
Adatte al funzionamento con aria e con vuoto

Polyurethane poppet seals and polyurethane pilot diaphragm
Guarnizioni otturatori e membrana pilotaggio in poliuretano

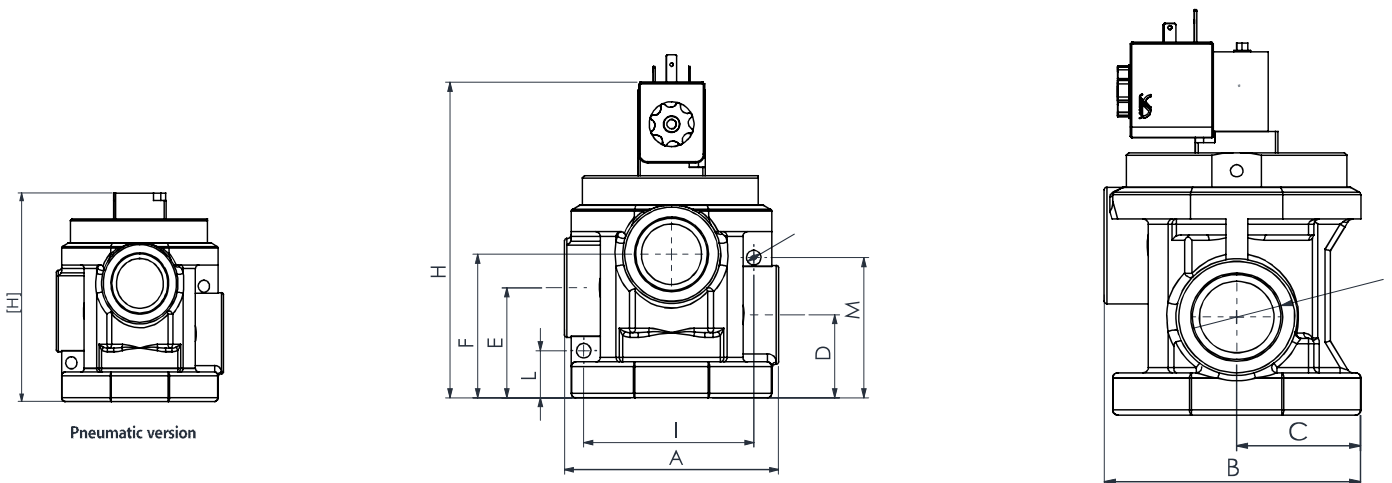

Pneumatic version

OVERALL DIMENSIONS (mm) [Pneumatic version]					
SIZE	G1/2"	G3/4"	G1"	G1 1/2"	G2"
A	78,5	78,5	101	158	210
B	75	75	94	138	183,5
C	35	35	45	84	79
D	30	30	38	68	92
E	41	41	51	68	92
F	50,5	50,5	64	98	129
G	G1/2"	G3/4"	G1"	G1 1/2"	G2"
H	128 [100]	128 [100]	144 [116]	193 [165]	265 [237]
I	63	63	76	113	150
L	21	21	25,51	34	48
M	54,5	54,5	62,5	113	152
N	Ø6,5	Ø6,5	Ø8,4	Ø11	Ø13

PV32 1S

Pneumatic Pilot / Comando Pneumatico **P**
 Solenoid Pilot / Comando Elettropneumatico **W**

Normally Closed (NC) / Normalmente chiusa **6**
 Normally Open (NO) / Normalmente aperta **9**

Standard **M**

External pilot Air Supply / Alimentazione Pilotaggio Esterno **E**

Size / Taglia

12 G1/2"

34 G3/4"

10 G1"

15 G1 1/2"

20 G2"

A Air / Aria

V Vacuum / Vuoto

TECHNICAL FEATURES					
SIZE	G1/2"	G3/4"	G1"	G 1 1/2"	G2"
AIR FLOW AT 6 bar [NI/min]	5500	6500	13500	35000	60000
VACUUM FLOW AT 755mmHg [m3/h]	20	35	90	180	250
PRESSURE RANGE [bar]	FROM 3 TO 10 BAR				
TEMPERATURE RANGE [°C]	FROM -20° TO 60° C				

VALVE FUNCTIONS / FUNZIONI VALVOLE

PV32P... PNEUMATIC PILOT

SIZE 1/2" ÷ 2"

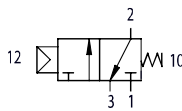

N.C. VACUUM

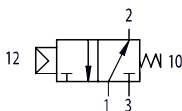

N.C. VACUUM

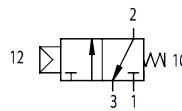

N.C. AIR

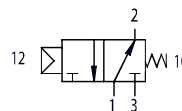

N.O. AIR



PV32W... SOLENOID VALVE

SIZE 1/2" ÷ 1"

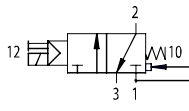

N.C. AIR

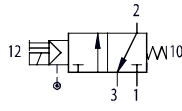

N.C. AIR
EXTERNAL AIR PILOT
PILOTAGGIO ESTERNO

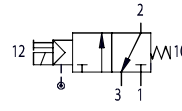

N.C. VACUUM
EXTERNAL AIR PILOT
PILOTAGGIO ESTERNO

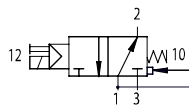

N.O. AIR

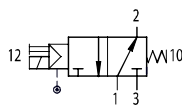

N.O. AIR
EXTERNAL AIR PILOT
PILOTAGGIO ESTERNO

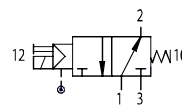

N.O. VACUUM
EXTERNAL AIR PILOT
PILOTAGGIO ESTERNO



PV32W... SOLENOID VALVE

SIZE 1 1/2" - 2"

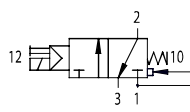

N.C. AIR

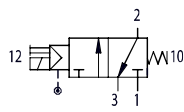

N.C. AIR
EXTERNAL AIR PILOT
PILOTAGGIO ESTERNO

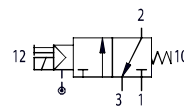

N.C. VACUUM
EXTERNAL AIR PILOT
PILOTAGGIO ESTERNO

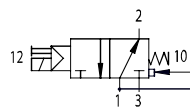

N.O. AIR

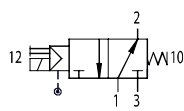

N.O. AIR
EXTERNAL AIR PILOT
PILOTAGGIO ESTERNO

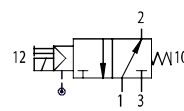

N.O. VACUUM
EXTERNAL AIR PILOT
PILOTAGGIO ESTERNO



SIMBOL / SIMBOLO

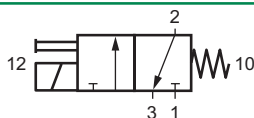

CODES / CODICI

Ordination code Codice ordinazione	Voltage Tensione
ELCDC - 00000	No coil / Senza solenoide
ELCDC - 01200	12 V DC
ELCDC - 02400	24 V DC
ELCDC - 02450	24 V 50/60Hz AC
ELCDC - 11050	110 V 50/60Hz AC
ELCDC - 22050	220 V 50/60Hz AC

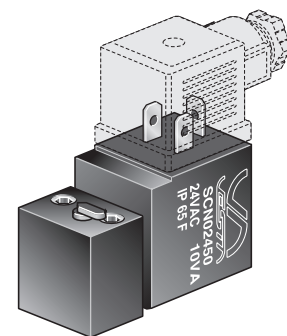
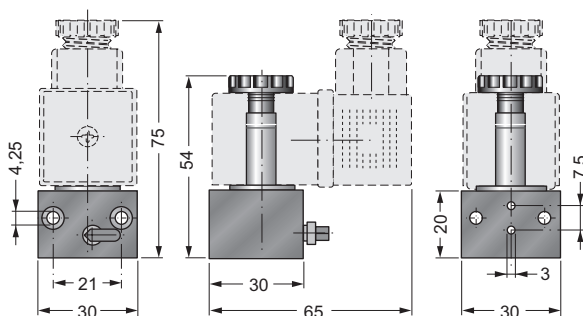

TECHNICAL FEATURES

Flow section	Ø 1,5 mm
Ambient temperature range	-10 °C ÷ +50 °C
Temperature range of medium	0 °C ÷ +50 °C
Lubrication	Not required
Medium	Filtered air
Operating pressure range	0 ÷ 10 bar
Reference temperature	+20 °C
Reference pressure	6 bar
Nominal air flow	100 NI / m in

CARATTERISTICHE TECNICHE

Diametro nominale	Ø 1,5 mm
Temperatura ambiente	-10 °C ÷ +50 °C
Temperatura fluido	0 °C ÷ +50 °C
Lubrificazione	Non necessaria
Fluido	Aria filtrata
Pressione d'esercizio	0 ÷ 10 bar
Temperatura nominale	+20 °C
Pressione nominale	6 bar
Portata nominale	100 NI / m in

COIL FOR **ELCDC** SOLENOID VALVE
SOLENOIDE PER ELETTROPILOTA

SCN

CODES / CODICI

Ordination code Codice ordinazione	Voltage Tensione
SCN01200	12 V DC
SCN02400	24 V DC
SCN02450	24 V 50/60Hz AC
SCN11050	110 V 50/60Hz AC
SCN22050	220 V 50/60Hz AC

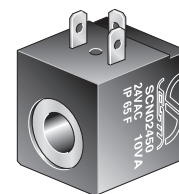
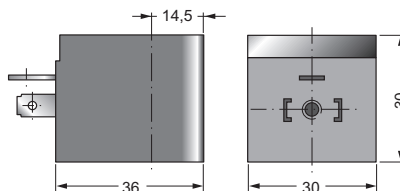

DIN 43650 - A

TECHNICAL FEATURES

Standard voltage	12, 24 V DC 24, 110, 220 V AC (50/60 Hz)
Solenoid characteristics	2,5 Watt in DC; 3,5 V A in AC
Voltage	± 10% (continuos)
Ambient temperature range	-20 °C ÷ +50 °C
Degree of protection	Fixed plug IP 65 with connector
Pins according	DIN 43650 - B
Insulation	Class F
Expy	Incapsulated

CARATTERISTICHE TECNICHE

Tensione standard	12, 24 V DC 24, 110, 220 V AC (50/60 Hz)
Prestazioni bobina	2,5 Watt in DC; 3,5 V A in AC
Tensione nominale	± 10% a bobina calda
Limiti di temperatura ambiente	-20 °C ÷ +50 °C
Protezione	IP 65 secondo IEC 144 con connettore e guarnizioni montate
Connessione elettrica	Secondo norma DIN 43650 - B
Bobina	Classe F, Filo rame classe 200 °C
Sovrastampatura	Resina epossidica

SOLENOID CONNECTOR FOR **SCN** COIL
CONNETTORE PER SOLENOIDE SERIE **SCN**

CEP/2

CODES / CODICI

Description Descrizione	Code Codice	Voltage Tensione
Universal connector Connettore universale	CEP/2	All tension Tutte le tensioni
Connector with led Connettore con led	CEP/2 L 10 / 50 CEP/2 L 70 / 250	10 / 50 V AC / DC 70 / 250 V AC / DC
Connector with led and varistor Connettore con led e varistore	CEP/2 LV 24 CEP/2 LV 110 CEP/2 LV 220	24 V AC / DC 110 V AC / DC 220 V AC / DC

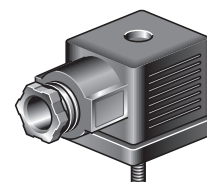
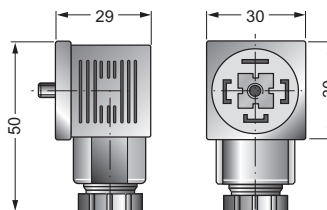

TECHNICAL FEATURES

Wire connection	With screwed terminals
Gland thread	PG 11
Number of poles	2 Poles + terra
Housing colour	Black, transparent in the led version

CARATTERISTICHE TECNICHE

Connessione cavi	Con morsetti a vite
Filettatura passacavo	PG 11
N° Poli	2 Poli + terra
Colori connettore	Nero, trasparente nella versione con led.